

Injection Molding- Jars & Closures



MARKETS

- Personal care
 - Skin Care
 - Hair Care
- Pharmaceutical
- Healthcare
- Nutraceutical
- Food
- CBD/Cannabis

CAPABILITIES

Our fully automated, touchless injection molding assembly and packing provides the highest quality jars. Mix and match closure options or custom color to create your signature brand. For a more sustainable choice, we offer up to 100% PCR and HEMP plastic alternatives. For tamper evidence, a variety of induction seal liners are available in our closures. Complete your package with our in-house decorating options.

RESIN/MATERIALS

PP • PS • PCR • HEMP

UV inhibitors and custom colors available.

PRODUCTS

- Heavy Wall
- Low Profile
- Double Wall
- Single Wall
- Radius Based
- Specialty
- Straight Closure
- Ribbed Closure
- Domed Closure

DECORATING CAPABILITIES

High-speed Pressure Sensitive top of closure labeling

High-speed Pressure Sensitive full wrap labeling

High-speed Pressure Sensitive front and back labeling

High-speed Pressure Sensitive spot labeling of jar bottom

Pad Printing



SUSTAINABILITY

IntraPac is dedicated to environmentally friendly manufacturing processes and packaging options.



- 100% PP recycle code 5
- Recycled Plastic- Post Consumer Recycled (PCR)
- Hemp Plastic

(1) Double wall jar options give a high end feel to your brand. Choose from our matte/textured or gloss finish. Mix and match with our different closures.

(2) The radius-based double wall jar provides a distinctive look. Add a custom color to deliver more shelf impact.

(3) The complete range of single wall jars can be used for food, tablets, gels, creams or lotions.

Jar Specifications

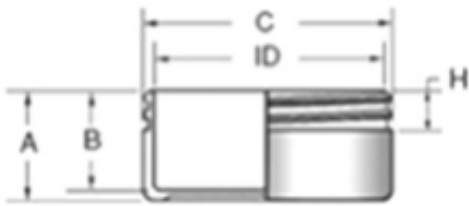

Low Profile Heavy Single Wall Jar

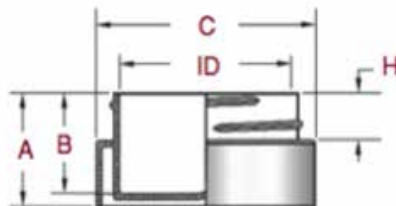

Specialty Single Wall Jar Spacewall Jar

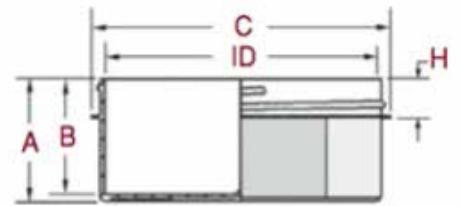

Specialty Single Wall Jar Ten-Sided Jar

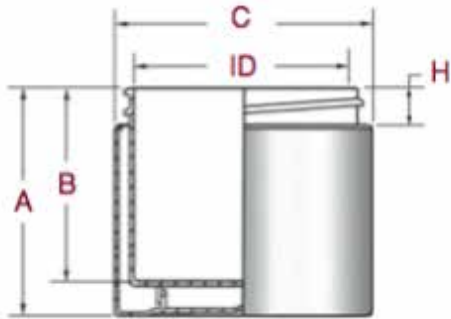

Straight Based Double Wall Jar

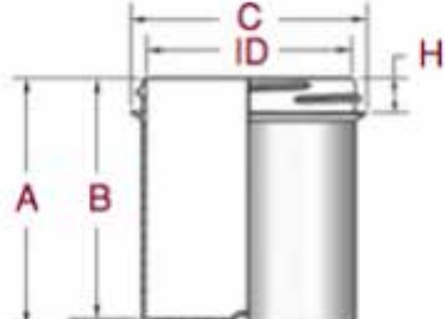

Straight Based Single Wall Jar

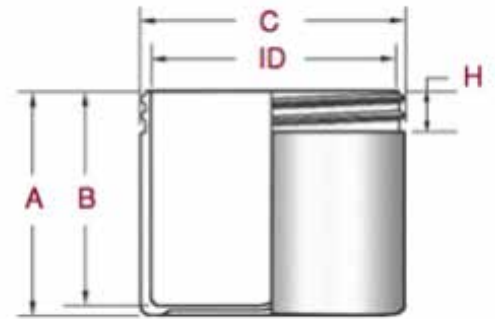

Heavy Wall Jar

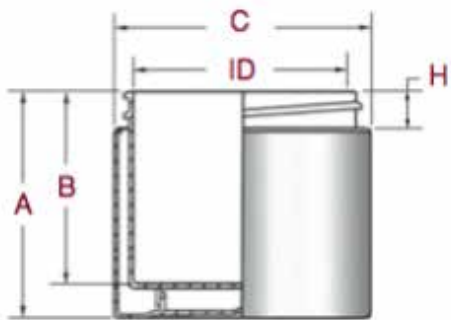

Straight Based Textured Double Wall Jar

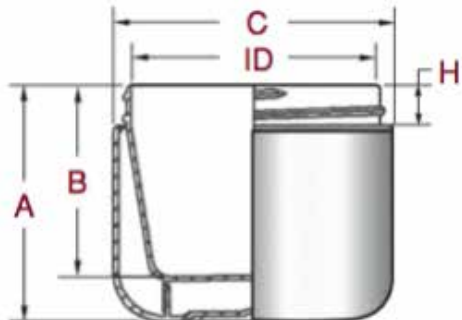

Radius Based Double Wall Jar

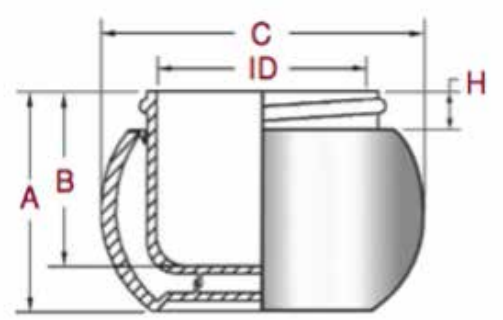

Specialty Single Wall Jar Globe Jar

Closure Specifications

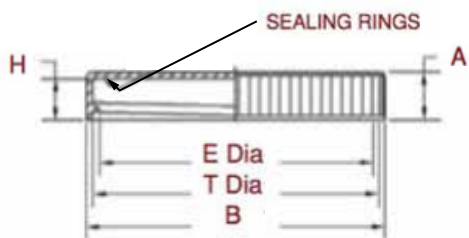

Ribbed Sided Smooth Top Jar Closure

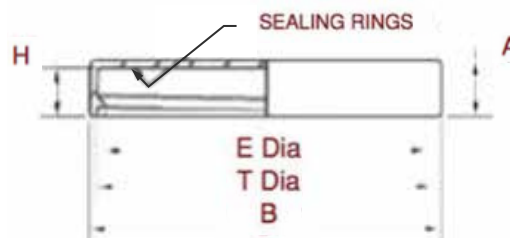

Smooth Straight Sided Jar Closure

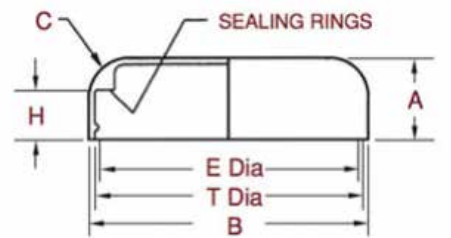

Domed Closure (Smooth or Textured)

LOW PROFILE HEAVY SINGLE WALL JAR SPECIFICATIONS

SIZE	NECK	MATERIAL	OFC	A	B	C	ID	H
1 oz	70 mm	PP	60 +/- 3.0 cc	.908 +/- .015	.770 +/- .015	2.843 +/- .015	2.490 +/- .015	.408 +/- .015
1 oz	70 mm	PS	65 +/- 3.25 cc	.920 +/- .015	.788 +/- .015	2.880 +/- .015	2.510 +/- .015	.408 +/- .015
2 oz	70 mm	PP	89 +/- 5 cc	1.295 +/- .015	1.183 +/- .015	2.836 +/- .015	2.490 +/- .015	.408 +/- .015
3 oz	70 mm	PP	100 +/- 5 cc	1.405 +/- .015	1.293 +/- .015	2.843 +/- .015	2.490 +/- .015	.408 +/- .015
3 oz	70 mm	PS	103.3 +/- 5.2 cc	1.430 +/- .015	1.305 +/- .015	2.898 +/- .015	2.515 +/- .015	.408 +/- .015
4oz	89 mm	PP	174 +/- 9 cc	1.49 +/- .020	1.348 +/- .015	3.624 +/- .015	3.242 +/- .015	.535 +/- .015
6 oz	89 mm	PP	-	1.965 +/- .015	1.853 +/- .015	3.64 +/- .015	3.24 +/- .015	.530/500 +/- .015

HEAVY WALL JAR SPECIFICATIONS

SIZE	NECK	MAT	GRAM WT	OFC	A	B	C	ID	H	*DECO AREA	PCS CARTON
1/4 oz	33 mm	PP	9.0 +/- 1 gr	14 +/- 2 cc	1.170 +/- .015	1.090 +/- .015	1.375 +/- .015	1.030 +/- .015	.403 +/- .015	-	1265
1/4 oz	33 mm	PS	11.5 +/- 1 gr	14 +/- 2 cc	1.173 +/- .015	1.090 +/- .020	1.388 +/- .015	1.034 +/- .015	.403 +/- .015	-	1265
3/4 oz	40 mm	PP	11.5 +/- 1 gr	27 +/- 2 cc	1.230 +/- .015	1.110 +/- .015	1.655 +/- .015	1.395 +/- .015	.315 +/- .015	.69 x 5.00"	864

STRAIGHT BASED SINGLE WALL JAR SPECIFICATIONS

SIZE	NECK	MAT	GRAM WT	OFC	A	B	C	ID	H	*DECO AREA	PCS CARTON
1/2 oz	33 mm	PP	3.8 +/- .19 gr	15.2 +/- 2.0 cc	1.140 +/- .012	1.089 +/- .012	1.241 +/- .024	1.05 +/- .015	0.359 +/- .015	-	1750
7/8 oz	33 mm	PP	6.2 +/- 1 gr	25 +/- 1.5 cc	1.944 +/- .012	1.838 +/- .012	1.265 +/- .024	1.046 +/- .015	.406 +/- .034	1.31 X 3.62"	1000
2 oz	48 mm	PP	13.2 +/- 1.0 gr	75 +/- 5 cc	2.325 +/- .015	2.205 +/- .015	1.948 +/- .015	1.650 +/- .020	.393 +/- .015	1.43 x 5.37"	420
2 oz	53 mm	PP	10.3 +/- 1.0 gr	75 +/- 4 cc	1.798 +/- .015	1.700 +/- .015	2.065 +/- .015	1.866 +/- .015	.408 +/- .015	1.00 x 6.00"	630
2 oz	53 mm	PS	12.2 +/- 1.0 gr	78 +/- 4 cc	1.816 +/- .015	1.710 +/- .015	2.084 +/- .015	1.880 +/- .015	.408 +/- .015	1.00 x 6.00"	630
4 oz	58 mm	PP	17.0 +/- 1.5 gr	135 +/- 5 cc	2.775 +/- .015	2.665 +/- .015	2.250 +/- .020	2.015 +/- .015	.408 +/- .015	1.93 x 6.43"	216
4 oz	70 mm	PP	19.5 +/- 1.5 gr	174 +/- 7 cc	2.280 +/- .020	2.170 +/- .020	2.690 +/- .015	2.520 +/- .015	.408 +/- .015	1.50 x 8.12"	273
4 oz	70 mm	PS	22.0 +/- 1.5 gr	182 +/- 7 cc	2.290 +/- .020	2.240 +/- .020	2.722 +/- .015	2.550 +/- .015	.408 +/- .015	1.50 x 8.25"	273
6 oz	70 mm	PP	22.6 +/- 1.0 gr	210 +/- 7 cc	2.768 +/- .015	2.637 +/- .015	2.682 +/- .015	2.513 +/- .015	.408 +/- .015	2.00 x 8.00"	210
6 oz	70 mm	PS	25.8 +/- 1.5 gr	218 +/- 7 cc	2.800 +/- .020	2.730 +/- .015	2.720 +/- .020	2.535 +/- .015	.408 +/- .015	2.00 x 8.06"	210
8 oz	70 mm	PP	27.0 +/- 2.0 gr	268 +/- 7 cc	3.500 +/- .020	3.450 +/- .020	2.685 +/- .015	2.515 +/- .015	.408 +/- .015	2.75 x 8.10"	195
8 oz	70 mm	PS	31.0 +/- 2.0 gr	278 +/- 7 cc	3.540 +/- .020	3.480 +/- .020	2.724 +/- .015	2.530 +/- .015	.408 +/- .015	2.75 x 8.19"	195
8 oz	89 mm	PP	30.5 +/- 3.0 gr	321 +/- 16 cc	2.545 +/- .015	2.460 +/- .020	3.446 +/- .015	3.255 +/- .015	.535 +/- .015	1.50 x 10.37"	161
8 oz	89 mm	PS	34.5 +/- 2.0 gr	334 +/- 12 cc	2.567 +/- .015	2.510 +/- .020	3.500 +/- .020	3.285 +/- .015	.535 +/- .015	1.50 x 10.43"	161
16 oz	89 mm	PP	40.5 +/- 2.0 gr	491 +/- 10 cc	3.790 +/- .020	3.710 +/- .020	3.530 +/- .020	3.280 +/- .015	.535 +/- .015	2.87 x 10.37"	60
16 oz	89 mm	PS	46.0 +/- 2.0 gr	513 +/- 10 cc	3.830 +/- .020	3.745 +/- .020	3.560 +/- .020	3.300 +/- .015	.535 +/- .015	2.87 x 10.68"	60
16 oz Snap Jar	89 mm	PP	27.5 +/- 1.5 gr	480 +/- 6 cc	3.695 +/- .015	3.652 +/- .020	3.395 +/- .015	3.260 +/- .015	-	3.30 x 10.67"	156

STRAIGHT BASED DOUBLE WALL JAR SPECIFICATIONS

SIZE	NECK	MAT	GRAM WT	OFC	A	B	C	ID	H	*DECO AREA	PCS CARTON
1/2 oz	48 mm	PP/PP	13.1 +/- 1.0 gr	22 +/- 3 cc	1.264 +/- .015	.800 +/- .020	2.035 +/- .015	1.370 +/- .015	.408 +/- .015	.49 x 6.18"	603
1/2 oz	48 mm	PS/PP	14.6 +/- 1.0 gr	22 +/- 3 cc	1.275 +/- .015	.810 +/- .020	2.035 +/- .015	1.375 +/- .015	.408 +/- .015	.49 x 6.21"	603
1 oz	53mm	PP/PP	17.5 +/- 1.5 gr	54 +/- 3 cc	1.580 +/- .015	1.200 +/- .015	2.200 +/- .015	1.855 +/- .015	.408 +/- .015	.81 x 6.62"	660
1 oz	53mm	PS/PP	18.5 +/- 1.5 gr	54 +/- 3 cc	1.590 +/- .015	1.200 +/- .015	2.200 +/- .015	1.855 +/- .015	.408 +/- .015	.87 x 6.87"	660
2 oz	58 mm	PP/PP	21.5 +/- 2.0 gr	75 +/- 4 cc	1.940 +/- .020	1.520 +/- .020	2.335 +/- .015	1.970 +/- .015	.408 +/- .015	1.12 x 7.06"	288
2 oz	58 mm	PS/PP	23.5 +/- 1.5 gr	75 +/- 4 cc	1.955 +/- .015	1.520 +/- .020	2.345 +/- .015	1.970 +/- .015	.408 +/- .015	1.12 x 7.18"	288
4 oz	70 mm	PP/PP	38.0 +/- 1.5 gr	142 +/- 7 cc	2.410 +/- .015	1.950 +/- .015	2.900 +/- .015	2.500 +/- .015	.408 +/- .015	1.56 x 8.75"	165
6 oz	70 mm	PP/PP	42.2 +/- 2.5 gr	208 +/- 5 cc	3.042 +/- .015	2.677 +/- .015	2.913 +/- .015	2.512 +/- .015	.408 +/- .015	2.17 x 8.80"	132
8 oz	89 mm	PP/PP	56.2 +/- 3.0 gr	280 +/- 14 cc	2.650 +/- .020	2.247 +/- .015	3.650 +/- .020	3.220 +/- .020	.515 +/- .015	1.69 x 11.25"	120
8 oz	89 mm	PS/PP	57.8 +/- 3.0 gr	280 +/- 14 cc	2.660 +/- .020	2.247 +/- .015	3.660 +/- .020	3.220 +/- .020	.515 +/- .015	1.69 x 11.25"	120
12 oz	89 mm	PP/PP	75.5 +/- 3.8 gr	375 +/- 7 cc	3.490 +/- .015	3.074 +/- .015	3.678 +/- .015	3.218 +/- .015	.535 +/- .015	2.50 x 11.31"	100

SPECIALTY SINGLE WALL JAR SPECIFICATIONS

SIZE	NECK	MAT	GRAM WT	OFC	A	B	C	ID	H	*DECO AREA	PCS CARTON
3/8 oz Spacewall	38 mm	PP	5.8 +/-	14.0 +/- 1.5 cc	.812 +/- .015	.720 +/- .020	1.700 +/- .015	1.250 +/- .015	.390 +/- .015	.25 x 5.25"	1300
1/2 oz Spacewall	38 mm	PP	10.0 +/-	17.6 +/- 0.9 cc	1.000 +/- .020	.880 +/- .020	1.700 +/- .015	1.250 +/- .015	.408 +/- .015	.37 x 5.25"	1000
2-5/8 oz Ten Sided	70 mm	PS	16.0 +/-	78.0 +/- 3.0 cc	1.090 +/- .015	.960 +/- .020	2.860 +/- .020	2.484 +/- .015	.385 +/- .015	-	350
2 oz Globe Jar	58 mm	PP/PP	38.5 +/- 2 gr	72 +/- 4 cc	1.980 +/- .020	1.517 +/- .015	2.60 +/- .020	1.97 +/- .015	.408 +/- .015	.91 x 1.72"	234

STRAIGHT BASED TEXTURED DOUBLE WALL JAR SPECIFICATIONS

SIZE	NECK	MAT	GRAM WT	OFC	A	B	C	ID	H	*DECO AREA	PCS CARTON
1/2 oz	48 mm	PP/PP	13.0 +/- 1.5 gr	22 +/- 3 cc	1.258 +/- .015	.795 +/- .015	1.260 +/- .020	1.370 +/- .020	.408 +/- .015	.50 x 6.00"	603
1/2 oz	48 mm	PS/PP	13.6 +/- 1.5 gr	22 +/- 3 cc	1.260 +/- .020	.795 +/- .015	1.260 +/- .020	1.370 +/- .020	.408 +/- .015	.50 x 6.00"	603
1 oz	53 mm	PP/PP	17.5 +/- 1.5 gr	55 +/- 3 cc	1.580 +/- .015	1.200 +/- .020	2.200 +/- .015	1.855 +/- .015	.408 +/- .015	.81 x 6.62"	660
1 oz	53 mm	PS/PP	18.5 +/- 1.5 gr	55 +/- 3 cc	1.590 +/- .015	1.200 +/- .020	2.200 +/- .015	1.855 +/- .015	.408 +/- .015	.88 x 6.87"	660
2 oz	58 mm	PP/PP	21.5 +/- 2.0 gr	75 +/- 4 cc	1.930 +/- .020	1.520 +/- .020	2.335 +/- .015	1.970 +/- .020	.408 +/- .015	1.12 x 7.06"	288
2 oz	58 mm	PS/PP	24.9 +/- 1.5 gr	75 +/- 4 cc	1.950 +/- .020	1.520 +/- .020	2.350 +/- .015	1.970 +/- .020	.408 +/- .015	1.12 x 7.18"	288
3 oz	63 mm	PP/PP	30.1 +/- 1.5 gr	114 +/- 5 cc	2.230 +/- .020	1.870 +/- .020	2.600 +/- .020	2.223 +/- .015	.408 +/- .015	1.43 x 8.00"	210
3 oz	63 mm	PS/PP	30.8 +/- 1.5 gr	114 +/- 5 cc	2.236 +/- .015	1.870 +/- .020	2.600 +/- .015	2.223 +/- .015	.408 +/- .015	1.43 x 8.00"	210
8 oz	89 mm	PP/PP	55.0 +/- 3.0 gr	282 +/- 10 cc	2.650 +/- .020	2.190 +/- .020	3.650 +/- .020	3.220 +/- .020	.515 +/- .015	1.69 x 11.30"	120

RADIUS BASED DOUBLE WALL JAR SPECIFICATIONS

SIZE	NECK	MAT	GRAM WT	OFC	A	B	C	ID	H	*DECO AREA	PCS CARTON
2 oz	58 mm	PP/PP	22.5 +/- 2.0 gr	74 +/- 4 cc	1.980 +/- .020	1.517 +/- .015	2.345 +/- .015	1.970 +/- .015	.408 +/- .015	1 x 7.18"	288
4 oz	70 mm	PP/PP	35.5 +/- 2.0 gr	143 +/- 7 cc	2.460 +/- .020	1.960 +/- .020	2.915 +/- .015	2.500 +/- .015	.408 +/- .015	1.31 x 9"	165

RIBBED SIDED SMOOTH TOP JAR CLOSURE SPECIFICATIONS

SIZE	MAT	GRAM WT	A	B	H	T	E	*DECO AREA	PCS CARTON
R 45 /400	PP	4.0 +/- .5 gr	.445 +/- .015	1.875 +/- .015	.397 +/- .009	1.748 +/- .007	1.654 +/- .007	-	1800
R 48 /400	PP	4.2 +/- .4 gr	.450 +/- .015	1.990 +/- .015	.397 +/- .009	1.880 +/- .009	1.784 +/- .007	-	1742
R 53 /400	PP	4.6 +/- .3 gr	.450 +/- .015	2.170 +/- .015	.397 +/- .009	2.075 +/- .007	1.981 +/- .007	-	1300
R 58 /400	PP	6.2 +/- .3 gr	.450 +/- .015	2.355 +/- .015	.397 +/- .009	2.227 +/- .007	2.132 +/- .007	-	1100
R 63 /400	PP	6.7 +/- .5 gr	.450 +/- .015	2.600 +/- .015	.397 +/- .009	2.469 +/- .007	2.375 +/- .007	-	900
R 70 /400	PP	1.8 +/- 1 gr	.455 +/- .015	2.850 +/- .015	.396 +/- .011	2.744 +/- .007	2.655 +/- .007	-	700
R 83 /400	PP	12.0 +/- 1 gr	.535 +/- .015	3.390 +/- .015	.476 +/- .009	3.279 +/- .010	3.159 +/- .010	-	425
R 89 /400	PP	16.0 +/- .8 gr	.605 +/- .015	3.653 +/- .015	.513 +/- .013	3.524 +/- .008	3.404 +/- .008	-	300

DOMED CLOSURES (SMOOTH OR TEXTURED) SPECIFICATIONS

SIZE	MAT	GRAM WT	OFC	A	B	H	T	E	*DECO AREA	PCS CARTON
RC 33 /400	PP	2.5 +/- .2 gr	22 +/- 3 cc	.455 +/- .015	1.390 +/- .015	R.125 +/- .015	.397 +/- .009	1.270 +/- .010	1.186 +/- .007	3500
RC 53 /400	PP	6.0 +/- .5 gr	22 +/- 3 cc	.635 +/- .015	2.205 +/- .015	R.375 +/- .015	.397 +/- .009	2.075 +/- .007	1.981 +/- .007	1300
RC 58 /400	PP	7.2 +/- 1 gr	54 +/- 3 cc	.700 +/- .015	2.360 +/- .015	R.500 +/- .020	.400 +/- .009	2.232 +/- .007	2.145 +/- .009	1100
RCT 58 /400 Textured	PP	7.2 +/- 1 gr	54 +/- 3 cc	.700 +/- .015	2.360 +/- .015	R.500 +/- .020	.400 +/- .009	2.232 +/- .007	2.145 +/- .009	1100
RCT 63 /400 Textured	PP	9.1 +/- 1 gr	75 +/- 4 cc	.676 +/- .015	2.604 +/- .015	R.437 +/- .015	.435 +/- .009	2.469 +/- .007	2.375 +/- .007	900
RC 70 /400	PP	10.0 +/- 1 gr	75 +/- 4 cc	.712 +/- .015	2.890 +/- .015	R.500 +/- .020	.418 +/- .015	2.752 +/- .009	2.652 +/- .009	700
RCT 70 /400 Textured	PP	11.0 +/- 1 gr	142 +/- 7 cc	.716 +/- .015	2.885 +/- .015	R.500 +/- .020	.415 +/- .015	2.744 +/- .007	2.650 +/- .007	700
RC 83 /400	PP	15.5 +/- 1 gr	208 +/- 5 cc	.890 +/- .015	3.420 +/- .015	R.630 +/- .020	.476 +/- .009	3.277 +/- .008	3.157 +/- .008	385
RC 89 /400	PP	16.4 +/- 1 gr	280 +/- 14 cc	.690 +/- .015	3.670 +/- .015	R.375 +/- .015	.460 +/- .010	3.512 +/- .008	3.400 +/- .008	300
RCT 89 /400 Textured	PP	16.4 +/- 1 gr	280 +/- 14 cc	.690 +/- .015	3.670 +/- .015	R.375 +/- .015	.460 +/- .010	3.512 +/- .008	3.400 +/- .008	300
RC 100 /400	PP	24.6 +/- 1.5 gr	375 +/- 7 cc	.912 +/- .015	4.100 +/- .015	R.375 +/- .015	.650 +/- .009	3.947 +/- .009	3.809 +/- .009	300

SMOOTH STRAIGHT SIDED JAR CLOSURES SPECIFICATIONS

SIZE	MAT	GRAM WT	A	B	H	T	E	*DECO AREA	PCS CARTON
H 33 /400	PP	2.2 +/- .3 gr	.435 +/- .015	1.365 +/- .015	.381 +/- .009	1.271 +/- .009	1.181 +/- .009	1.06 +/- .125	3500
H 38 /400	PP	2.9 +/- .3 gr	.450 +/- .015	1.580 +/- .015	.398 +/- .010	1.484 +/- .007	1.404 +/- .007	-	2700
H 43 /400	PP	3.8 +/- .5 gr	.440 +/- .015	1.760 +/- .015	.394 +/- .011	1.650 +/- .010	1.575 +/- .010	-	2000
H 45 /400	PP	4.2 +/- .5 gr	.440 +/- .015	1.855 +/- .015	.382 +/- .009	1.746 +/- .007	1.654 +/- .007	-	1800
H 48 /400	PP	6.2 +/- .5 gr	.466 +/- .015	2.038 +/- .015	.397 +/- .009	1.880 +/- .009	1.784 +/- .007	-	1742
H 53 /400	PP	4.4 +/- .5 gr	.455 +/- .015	2.165 +/- .015	.400 +/- .009	2.075 +/- .007	1.981 +/- .007	1.81 +/- .125	1300
H 58 /400	PP	5.7 +/- .5 gr	.450 +/- .015	2.330 +/- .015	.397 +/- .009	2.232 +/- .007	2.138 +/- .007	-	1100
H 63 /400	PP	7.1 +/- .5 gr	.450 +/- .015	2.600 +/- .015	.397 +/- .009	2.469 +/- .007	2.377 +/- .009	-	900
H 70 /400 T	PP	8.7 +/- .5 gr	.440 +/- .015	2.905 +/- .015	.389 +/- .009	2.754 +/- .007	2.660 +/- .007	-	700
H 70 /400 A	PP	8.5 +/- 1 gr	.450 +/- .015	2.840 +/- .015	.394 +/- .012	2.744 +/- .007	2.650 +/- .007	2.5 +/- .125	700
H 70 /400 High Top	PP	16.5 +/- 1.65 gr	.902 +/- .015	2.884 +/- .015	.397 +/- .009	2.744 +/- .007	2.650 +/- .007	-	462
H 83 /400	PP	12.0 +/- 1 gr	.525 +/- .015	3.390 +/- .015	.469 +/- .009	3.277 +/- .008	3.157 +/- .008	-	425
H 89 /400 Textured	PP	18.8 +/- 1 gr	.610 +/- .015	3.665 +/- .020	.524 +/- .009	3.520 +/- .008	3.400 +/- .008	3.000 +/- .125	300
H 89 /400	PP	14.8 +/- 1 gr	.570 +/- .015	3.641 +/- .015	.498 +/- .015	3.521 +/- .009	3.410 +/- .010	3.31 +/- .125	300
H 100 /400	PP	20.0 +/- 1.5 gr	.650 +/- .015	4.070 +/- .015	.578 +/- .010	3.940 +/- .010	3.830 +/- .010	-	300